

## Rear Suspension

17. Collect the spacer tube.

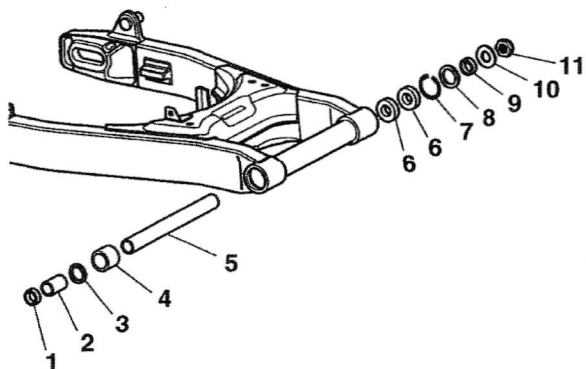

1. Spacer
2. Sleeve
3. Seal
4. Needle roller bearing
5. Spacer tube
6. Ball Bearing
7. Circlip
8. Seal
9. Spacer
10. Washer
11. Nut

**Note:**

- The needle roller bearing in the left hand side of the arm cannot be removed undamaged.

18. If required, renew the drive belt (see page 15-8).

### Inspection

1. Check all swinging arm bearings for damage, pitting, and cracks. Replace as necessary.
2. Check the swinging arm for damage. Replace as necessary.
3. Check the wheel bearings for damage, pitting, and cracks. Replace as necessary.
4. Check all bearing seals for damage, splits etc. Replace as necessary.
5. Check the drive belt for wear, damage etc. Replace as necessary.
6. Check both drive belt pulleys for wear, damage etc. Replace as necessary.

### Installation

1. Install the bearings (marked faces outwards), sleeves and seals etc. into the swinging arm in the order shown on the previous page. Use new seals throughout.
2. Position the swinging arm to the frame.
3. Refit the swinging arm spindle from the right hand side such that it will support the swinging arm, but not pass all the way through the frame adjuster sleeve. This will allow tool T3880104 to engage in the slot in the frame adjuster sleeve.
4. Using tool T3880104, tighten the frame adjuster sleeve to **6 Nm**.

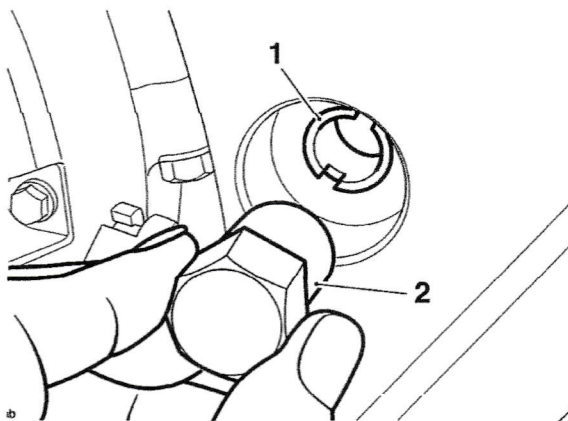

1. Frame adjuster
2. Tool 3880104

5. Fully insert the swinging arm spindle.
6. Fit the washer and a new swinging arm spindle nut, tighten the nut to **110 Nm**.
7. Refit the coolant expansion tank to its bracket.
8. Refit the two flanged sleeves and secure with new nuts, tighten the nuts to **3 Nm**.
9. Check and if necessary top up the coolant level (see page 11-5).
10. Refit the drive belt pulley cover and secure with the four fixings. Tighten to **9 Nm**.